

2 cabins - 2 head compartments

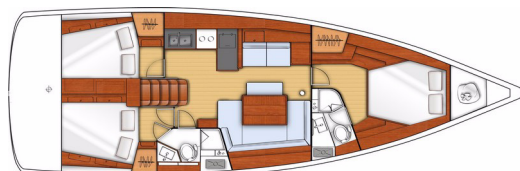

3 cabins - 2 head compartments



GENERAL SPECIFICATIONS

• L.O.A	13,94 m	45'9"
• Hull length	13,50 m	44'3"
• L.W.L.	12,98 m	42'7"
• Beam	4,50 m	14'9"
• Deep draught	2,27 m	7'5"
• Deep ballast weight	2 808 kg	6,191 lbs
• Shallow draught	1,75 m	5'9"
• Shallow ballast weight	3 036 kg	6,693 lbs
• Air draught	20,60 m	67'7"
• Light displacement	10 549 kg	23,257 lbs
• Fuel capacity	200 l	53 US Gal
• Freshwater capacity (standard)	370 l	98 US Gal
• Freshwater capacity (Optional equipment)	200 l	53 US Gal
• Engine power	54 HP	54 HP
	POD 90	POD 90

ARCHITECT / DESIGNERS

- Naval Architect: Finot - Conq And associs
- Interior design: Nauta Design

EC CERTIFICATE

- Category A - 10 persons
- Category B - 11 persons
- Category C - 12 persons

STANDARD SAIL LAYOUT AND AREA

• Mainsail (classic)	50,00 m ²	538 sq ft
• Genoa (104 %)	50,00 m ²	538 sq ft
• Asymmetrical spinnaker	156,00 m ²	1,679 sq ft
• I	17,43 m	57'2"
• J	5,65 m	18'6"
• P	16,36 m	53'8"
• E	5,43 m	17'10"

STANDARD EQUIPMENT

CONSTRUCTION

- Design in accordance with European Directive requirements and according to EC certification
- Monolithic hull design in polyester
- Monolithic structural inner moulding bonded to the hull
- Injection moulded deck in glass fibre/balsa sandwich, covered with «diamond-point» non-slip coating
- Hull-deck join screwed, bonded and trimmed with 1 bulwark
- Cast iron keel fixed with bolts and stainless steel backing plates
- Rudder hung with glass compound stock
- White coloured hull - Grey metal hull graphics

DECK EQUIPMENT

RIGGING

- Standard mast 9/10 electro-polished aluminium installed on the deck, 2 aft-swept spreaders
- Anodised aluminium boom
- Discontinuous stainless steel standing rigging
- 2 Backstays with bottlescrews
- Rigid boom vang with tackle
- Genoa furling system with drum on the deck
- 2 Blocks Stand Up on mainsheet arch
- 2 genoa tracks with piston adjusted traveller cars
- 2 Genoa sheet return blocks
- Rigging run back to cockpit (except boom topping lift)
- Complete running rigging: Main halyard, genoa halyard with clutch on mast and cleat, Boom topping lift with cleat on mast, Mainsheet, 2 Genoa sheets 2 rapid reefing lines, 1 manual reef
- 7 Jammers
- 2 halyard bags

WINCHES

- 2 Self-tailing genoa sheet winches (H50.2 STC)
- 2 Self tailing coachroof winches (H40.2 STC)
- 2 Aluminium winch handles Speed Grip
- 2 Winch handle boxes

SAILS

- Furling genoa with UV protective strip
- Semi full batten written sail with slider and roller slider
- System: Lazy Jack and Lazy Bag in Natural colour

MOORING LINES -MOORING

- Self-bailing chain locker - Clench bolt - Hatch cover
- Single roller stainless steel bow fitting with offset roller
- 1 12 V - 1000 W Vertical electrical windlass - Remote control
- 6 Aluminium mooring cleats - Stainless steel deck line protection

SAIL LOCKER

- Access through deck hatch T60
- Stainless steel ladder
- Shelving

SAFETY ON DECK

- 1 Open stainless steel forward pulpit - Step
- 2 Stainless steel aft pushpits
- 1 Lifebuoy support bracket
- 1 Outboard engine bracket
- Ring for flag welded on balcony
- Double guardrail and stainless steel stanchions - Opening to port and to starboard in guardrail

COCKPIT

- Self-draining cockpit
- 2 Cockpit locker
- 2 Lockers in cockpit sole beneath helm's feet
- 1 Liferaft locker under helm seat, in cockpit bottom (0,80 m x 0,40 m x 0,58 m / 2'7" x 1'4" x 1'11")
- 1 Gas locker for bottle(s) under the port helm seat
- Natural solid wood slatted cockpit benches
- 2 Steering wheel consoles: Stainless steel steering wheels - 900 mm diameter - leather covered - Steering gear at the helm station - metal cable transmission system - Stainless steel handrail - navigation instrument support (optional instruments) - Glass holder
- 1 Deck hole for access to tiller system + Power supply access hatch
- 1 Tiller
- 2 Steering compass on binacelle
- Portside engine control and control panel
- Polyester cockpit table - 2 flaps - oddments locker - 2 Large storage space - 2 Stainless steel handrails - 12 V socket - lamp with shade
- 1 Cold water cockpit shower hose
- 1 Fixed composite arch - Built-in lighting
- 2 Hinged PMMA companionway doors - Sliding hatch made of PMMA

SWIM DECK / STERN DECK

- Fully opening transom, convertible to bathing platform (2,85 m x 0,77 m / 9'4" x 2'6")
- Electrically controlled opening
- Natural solid wood decking on sun deck
- 1 Stainless steel swim/boarding ladder - solid wood steps - folding

INTERIOR

- Woodwork Alpi Mahogany
- Parquet type laminated floors
- Fabric hull linings in saloon and cabins
- Fabric upholstery - Marine mattresses in the cabins

COMPANIONWAY

- Headroom: 2,00 m / 6'7"
- Wooden saloon companionway with moulded wood suspended steps with non-slip surface
- 2 Stainless steel handrails

SALOON

- Headroom: 1,97 m / 6'6"
- U shaped saloon bench - double density foam
- Central seating on pantograph
- Saloon table in 1 piece - Varnished wood top with inlay - Aluminium legs
- Mirror on bulkhead
- Cupboards - Shelves and stowage along the hull - Storage under bench seats
- Shelves with stainless steel fiddles
- 2 Panoramic deck house windows with concertina blinds
- 2 Hull portholes with curtain
- 2 Opening portholes on coaming in side windows
- 1 Opening deck hatch with blind / Mosquito net

CHART TABLE - PORT SIDE

- Sliding, can be configured with the armchairs - Placed against the forward bulkhead, against the galley or between the 2 mobile seats
- Table with flap - Moulded wood fiddle
- Switch panel on bulkhead for access to electrical functions
- 1 White reading light / Red

GALLEY - PORT SIDE

- Headroom: 2,00 m / 6'7"
- L-shaped kitchen
- Compact grey laminated worktop
- 1 Stainless steel sink 2 rectangular basins - 1 Mixer tap cold water / hot water, under pressure
- 1 Gas cooker 2 burners - Stainless steel oven on mountings - Stainless steel protection handrail
- 1 85 litre ice box / 22 US Gal, top opening
- 1 12 V 130 litre refrigerator / 34 US Gal, front opening
- Fitted lockers and closed shelving (Shelving, Bin)
- 1 Base cabinet: 1 Drawer - 2 shelves
- 1 Opening portlight with curtains in side windows in the coaming
- Storage space along the hull

STARBOARD AFT CABIN

- Headroom: 1,96 m / 6'5"
- 1 Double bed (2,05 m x 1,50 m x 1,15 m / 6'9" x 4'11" x 3'9") - Marine mattress
- Access door to starboard aft washroom
- Cupboards - Hanging locker - Closed shelving
- Stowage on both sides of berth
- 1 Hull portholes with curtain
- 1 Cockpit windows with curtains
- 1 Cockpit porthole with curtain
- 1 flush deck hatch with blind / Mosquito net

STARBOARD AFT HEAD COMPARTMENT

- Headroom: 1,88 m / 6'2"
- Access through saloon and the starboard aft cabin
- Separate shower - 1 Mixer tap hot water / Cold water
- 1 Manual marine toilet
- 1 Rigid holding tank 80L / 21 US Gal
- Basin - 1 Mixer tap hot water / Cold water
- Washroom cabinet
- 2 Mirrors
- Toilet accessories
- Cupboard
- 1 Opening portlight with curtains in side windows in the coaming

Version 2 cabins

AFT-GALLEY (PORT AFT)

- Access via galley
- Large storage area (Numerous cupboards, shelves, Drawers)
- Access door to port cockpit locker
- 1 flush deck hatch with blind / Mosquito net

Version 3 cabins

PORT AFT CABIN

- Headroom: 1,96 m / 6'5"
- 1 Double bed (2,05 m x 1,50 m x 1,15 m / 6'9" x 4'11" x 3'9")
- Cupboard - Hanging locker - Closed shelving
- Stowage on both sides of berth
- 1 Hull porthole with curtain
- 1 Cockpit porthole with curtain
- 1 flush deck hatch with blind / Mosquito net
- 1 Cockpit windows with curtains

FORWARD CABIN

- Headroom: 1,89 m / 6'2"
- Central double bed (2,05 m x 1,50 m x 1,15 m / 6'9" x 4'11" x 3'9")
- Hanger closets - Valet tray - Cubby hole locker - Base cabinet - Stowage under platform
- 3 flush deck hatches with blinds / Mosquito net
- 2 Hull portholes with curtain

STARBOARD FORWARD HEAD COMPARTMENT

- Headroom: 1,85 m / 6'4"
- Access through forward cabin
- Manual marine toilet
- Moulded basin - shower mixer tap hot / Cold water
- Separate shower - 1 Mixer tap hot water / Cold water
- 1 Mirror
- Washroom cabinet
- Toilet accessories
- Cupboard
- 1 flush deck hatch with blind / Mosquito net

ENGINE

- Engine Yanmar Diesel 54 hp / 54 HP Sail Drive or POD 90 Dock & Go
- Engine control - Control panel in the port cockpit
- Engine compartment: Soundproofing foam - Ventilation: 1 air intake and 1 pressured air outlet
- 1 Alternator 12 V / 125 Ah
- 1 Rotomoulded diesel tank 200 L / 53 US Gal (under port aft berth) - Electronic gauge - Low level alarm - 1 Deck filler
- Filters: Sea water - Diesel - Decanter
- Fixed three blades propeller
- 1 Engine access through companionway (opening with 2 gas struts) - 2 Engine access through aft cabins

ELECTRICITY

- 12 V circuit
- 2 service batteries (110 Ah) - 1 Engine battery (110 Ah)
- 1 Power distributor
- 12 V Electrical panel (Fuses - Voltmeter - Water gauge - Fuel gauge - Battery warning - Fuel warning - Water warning)
- 1 12 V Sockets
- Lighting: Overhead lights - Reading lights - Reading light White/red - White strip-lighting
- Navigation lights: 1 Forward and aft navigation lights - 1 Engine navigation light / Spreader light forward of mast - 1 Anchor light on masthead
- Wire runs for options cables
- Full 220 V system (Interior sockets 220 V - 25 Amperes battery charger - Shore power socket)

PLUMBING

- 1 rotomoulded freshwater tank (330 l / 87 US Gal Forward cabin) - 1 Deck filler
- Pressurised electric water pump - Expansion tank - Inline filter
- 40 L Electric water heater / 11 US Gal (engine run)
- 1 Rigid holding tank 80L / 21 US Gal
- Delayed shower draining and electric shower drain pumps
- 1 Electric bilge pump - 1 Manual bilge pump
- 1 Electric ice box drain pump

GAS

- 1 Gas bottle box in the cockpit (Diameter 0,34 m x 0,53 m / 1'1" x 1'9")
- Regulator and safety tap

TRIM LEVEL

	AVANTAGE	ELEGANCE
B&G Electronic : 2 Multifunction Zeus 7" wide screens (GPS - Chart plotter - Chart reader - Cartography Navionics Silver included)	■	■
B&G Electronic : Wind Sensor (Windvane, Anemometer)	■	■
B&G Electronic : Sensor (Loch - Speedometer - Temperature)	■	■
B&G Electronic : Wifi interface	■	■
Additional bow roller + Stainless steel bobstay	■	■
Cockpit shower hot - Cold water	■	■
SonicHub™ - Interior loudspeakers - Exterior loudspeakers	■	■
LED: Navigation light - Interior lighting	■	■
Saloon: Indirect lighting LED	■	■
60 Amp battery charger instead of 25 Amp charger, standard	■	■
2 110 amperes additional service batteries	■	■
Storage space(s) under the floor	■	■
Stainless steel beading for fenders in cockpit locker	■	■
Releasable fore-stay chain-plate		■
1 Port electric coachroof winch H46.2 STECH		■
Cockpit sole natural solid wood		■
Polyester/wood cockpit table - White PVC protective cover		■
Saloon: Leather covering on stainless steel guardrails interiors		■
Galley: Sea water foot pump + Fresh water		■
Galley: Stainless steel 2 burner oven/grill cooker on deluxe mounting		■
Galley: 12 V refrigeration unit in icebox - Freezer		■

PACKS

	DOCKING (IF DOCK & GO)	EASY DOCKING (NOT AVAILABLE WITH DOCK & GO)	ELECTRONIC B&G
Windlass control in cockpit with chain counter	■	■	
White PVC steering wheel covers	■	■	
Moorings lines, Mooring, Fenders	■	■	
Bow thruster		■	
Swivel base on reverse side of cockpit table			■
Cockpit: Multifunction touchscreen B&G Zeus 12" wide (GPS, Chart plotter, Chart reader - Cartography Navionics Silver included)			■

VERSION

	DOCK & GO
Engine YANMAR Diesel Dock & Go POD 90	■
Swivel Sail Drive base	■
Joystick	■
Vessel Management Unit (VMU)	■
Bow thruster	■
Auto pilot	■

OPTIONAL EQUIPMENT

Navigation electronics B&G

- 4G Radar
- AC 42 autopilot + Control at steering station
- Chart table: Zeus 7" wide additional multifunction screen
- Chart table: Fixed B&G+V50 VHF, function AIS receiver + H50 cockpit handset
- AIS 400

Rigging - Sails

- 2 flag halyards
- Releasable fore-stay chain-plate
- Asymmetrical spinnaker rigging + Code 0 Rigging
- Self-tacking jib hardware
- Code 0 on furler
- Tacking jib (replacing genoa)
- self-tacking staysail with manual furling + Fixed forestay
- Anodized mast furling system with Mylar-Taffetas mainsail
- Genoa sheet track leads adjustable from the cockpit
- Backstays with bottlescrews (Adjustable)*

Winches

- Electric genoa sheet winches - H46.2 STCEH / 50.2 STC

Hull - Deck

- Grey "Perle" hull
- Blue-grey hull
- Solid wood slatted catwalks
- Silver Coachroof sprayhood
- Silver Cockpit Bimini
- Dark Narval Cockpit cushions
- 3 retractable blades propeller
- Refrigerated ice-box in cockpit table (30 L / 8 US Gal) - Positive cold
- Windex Windvane
- White composite steering wheels
- Stainless steel Arch with davits
- Mooring cleats - Stern deck

Interior equipment

- 6 KVA Generator
- Inverter 12 V / 220 V 2000 VA
- 220V Microwave oven
- Dishwasher (Available only in 2-Cabin version)
- Forced air heating fuel
- 220 V Air conditioning / 50 Hz
- Water maker (60 l / 16 US Gal / Hour)
- Double berth in saloon
- Additional holding tank
- QUIET FLUSH electric toilet
- Extra water tank 200 L / 53 US Gal
- TV LCD 24" + Player Fusion (Bluetooth, USB, Dvd, MP3), in the saloon
- Mosquito nets to port
- Grey upholstery padding in all cabins or Taupe
- De luxe folding saloon table (double berth compatible)
- Slat mattresses
- Interior upholstery, according to swatches

* Except on mast with in-mast furling

